

KDS Series

Full line of knock down Showers & Tub showers

Thanks to our **EASY STEPS** installation, you're saving time and money with AKER.

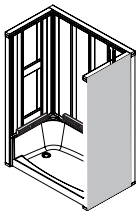

Step 1

Level and install the shower base or the bathtub in the alcove.

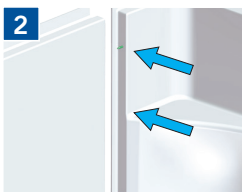

Step 2

Apply silicone and install the walls using the PIN system to guide them in place. (Install the back wall and slide the side walls in).

Step 3

Secure the wall parts to the studs (shim if necessary).